

Courses & distances up the West side of Johnston Run from Beech

N	5°	W	8 P ^e
N	46	E	8
N	19	W	12
N	27	E	7
N	20	W	7
N	83	W	8.5
N	12	W	8
N	32	W	7
N	43	E	4
N	40	W	4
N	23	W	10
N	57	E	5
N	19	W	4
N	3	E	8
N	34	W	6
N	9	E	5
N	68	E	5
N	39	W	3 to post

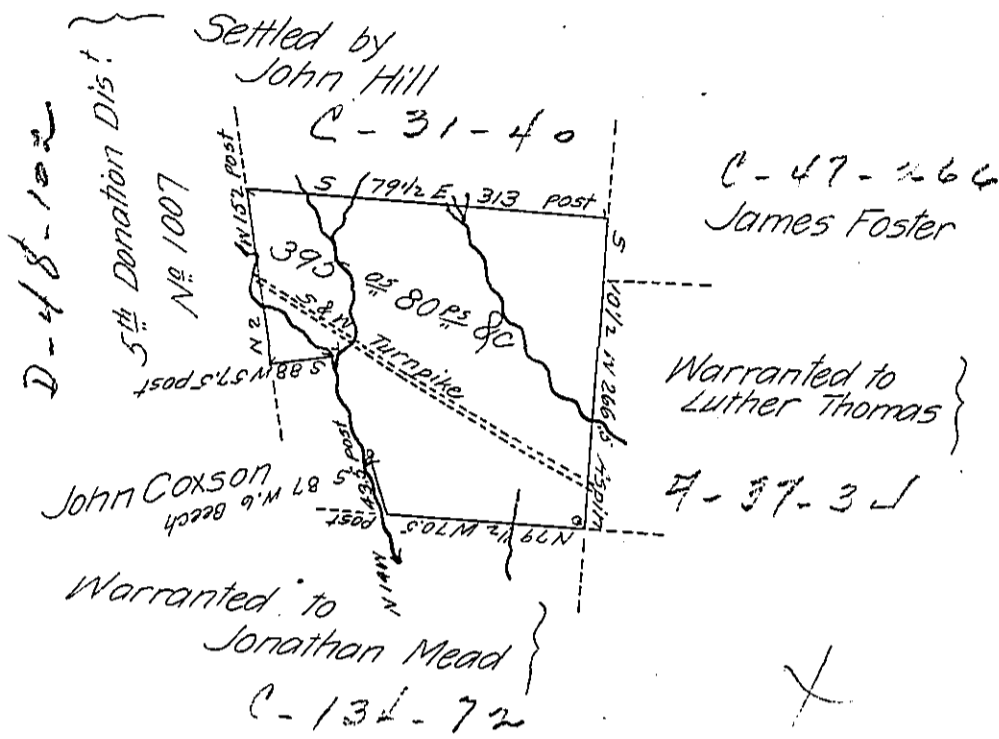

Draft of a tract of land situate in Canal township, Venango county, west of the Allegheny River, on the waters of Sugar Creek. Surveyed 18th November 1837 for M^{rs} Patty Plumer on the improvement & actual settlement of John Johnston.

John Taylor Esq^r
Surveyor General of Pa^a

Rich^d Irwin D.S.

IN TESTIMONY that the above is a copy of the original remaining on file in the Department of Internal Affairs of Pennsylvania, made conformably to an Act of Assembly approved the 16th day of February, 1833, I have hereunto set my Hand and caused the Seal of said Department to be affixed at Harrisburg, this twelfth day of June 1906

Geo. P. Brown
Secretary of Internal Affairs.